

Harvest Fellowship

Site Development Progress Report

June 13, 2010



"Here I am! I stand at the door and knock. If anyone hears my voice and opens the door, I will come in and eat with him, and he with me."

Revelation 3:20

Site Plan

The General Contractor is responsible for all bid items reviewed in the contract documents. All bids shall state that the bidder reviewed all the contract documents for coordination with their work.
 HUFFMORRIS ARCHITECTS & SITE PLANNING, INC. 15000 BATTERY PARK DRIVE, SUITE 200, FALLS CHURCH, VA 22046

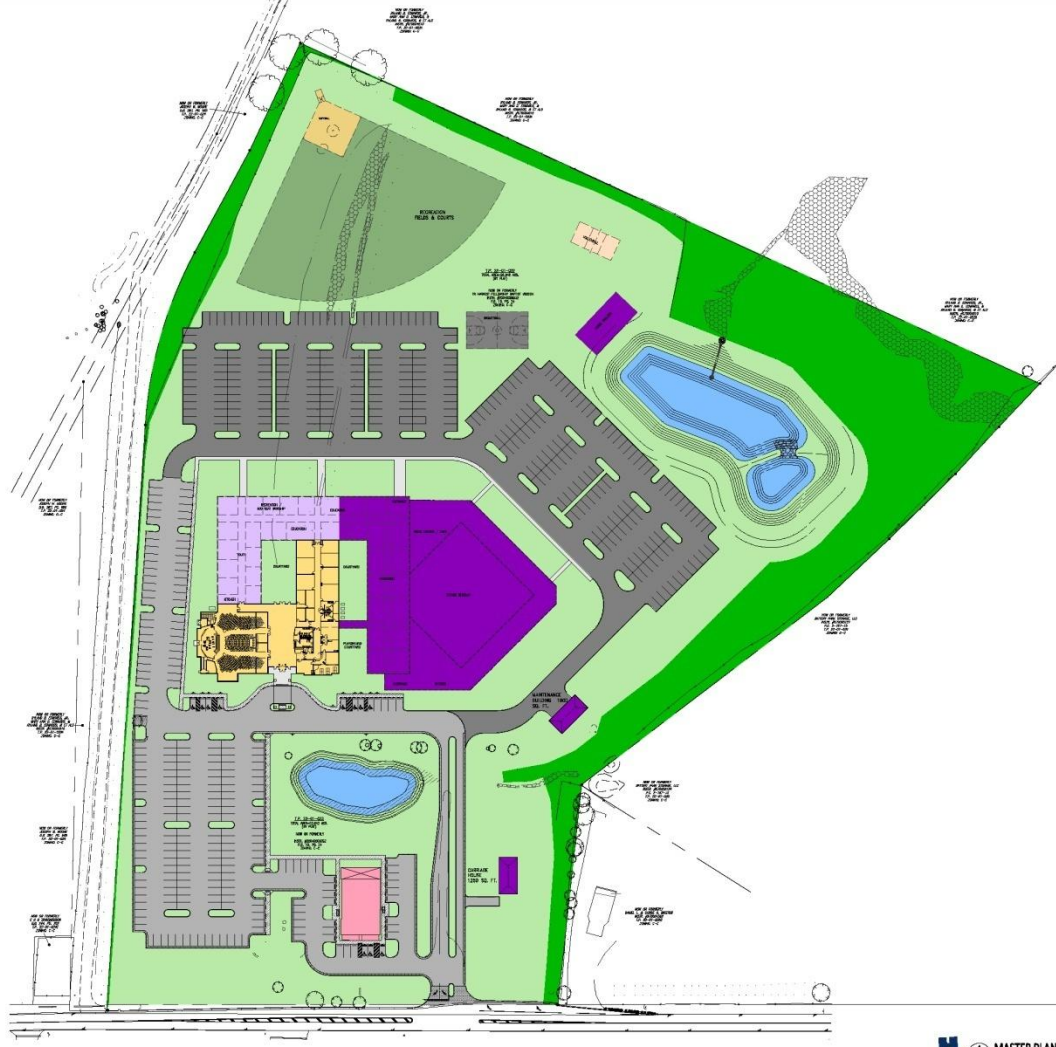

H **W** **A** **MASTER PLAN**
 SCALE: 1"=50'-0"

HUFFMORRIS ARCHITECTS
 400 EAST SPANGLER STREET, FRODO, VIRGINIA 22618
 WWW.HUFFMORRIS.COM



**HARVEST FELLOWSHIP
 BAPTIST CHURCH**
 15000 BATTERY PARK DRIVE, SUITE 200, FALLS CHURCH, VA 22046
 SCHEMATIC DESIGN

24 March 2010
 Master Plan

Celebrating Our 80th Anniversary

MP1.1

Site Plan

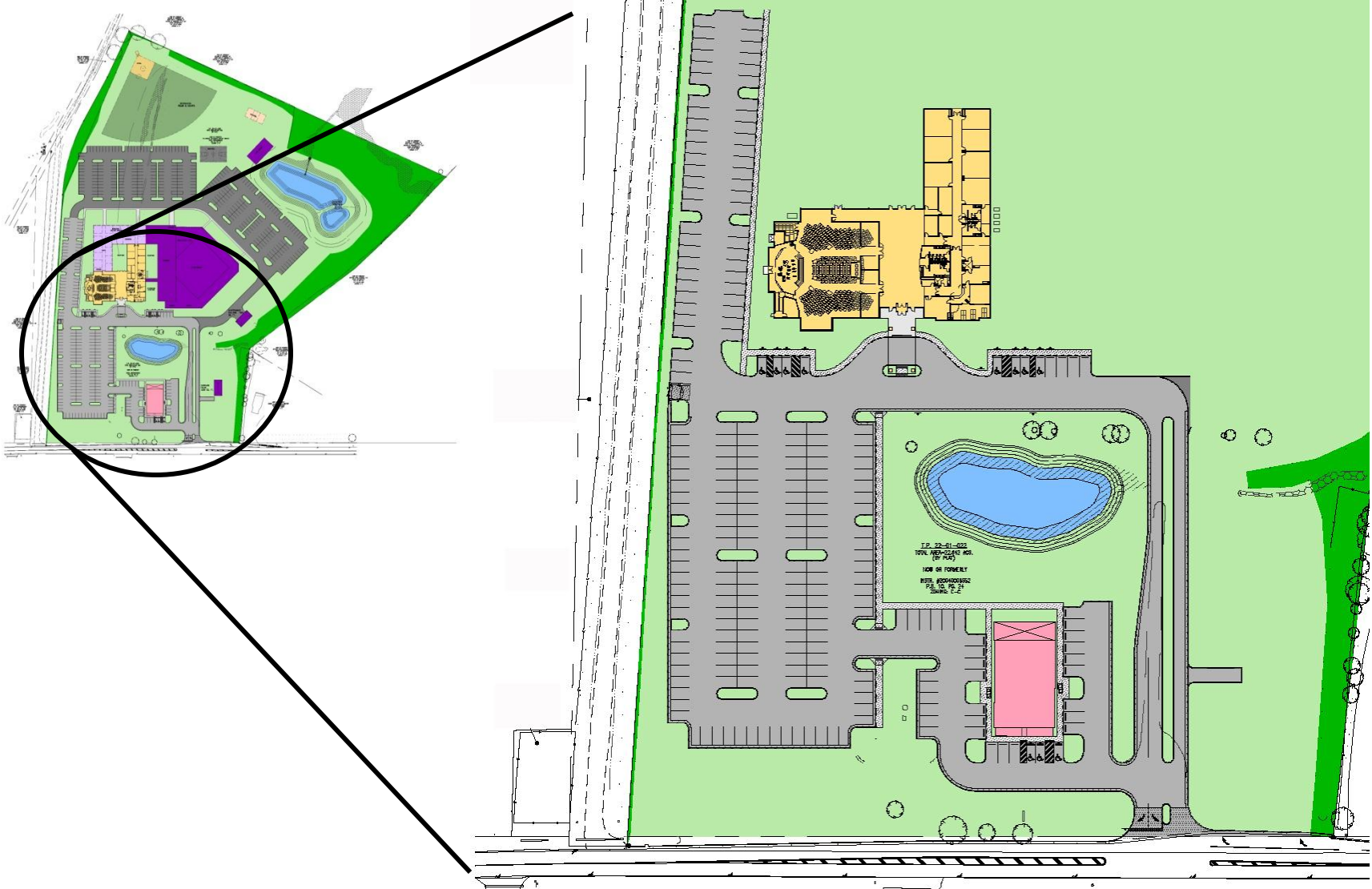

Phase 1 Building



Phase 1 Building Plan

The General Contractor is responsible for all hidden reviewing of the contract documents. All bids shall state that the bidder reviewed all the contract documents for coordination with their work.
 HUFF MORRIS ARCHITECTS P.C. IS THE AUTHOR AND OWNER OF THESE INSTRUMENTS OF SERVICE.

A FLOOR PLAN
 SCALE: 1/8" = 1'-0"



**HARVEST FELLOWSHIP
 BAPTIST CHURCH**
 16300 Bluffway Park Road, Richmond, Virginia 23234
 SCHEMATIC DESIGN

HUFF MORRIS ARCHITECTS
 400 EAST GRACE STREET, RICHMOND, VIRGINIA 23219
 WWW.HUFFMORRIS.COM

Celebrating Our 75th Anniversary

24 March 2010
 floor plan

A1.1

Phase 1 Sanctuary

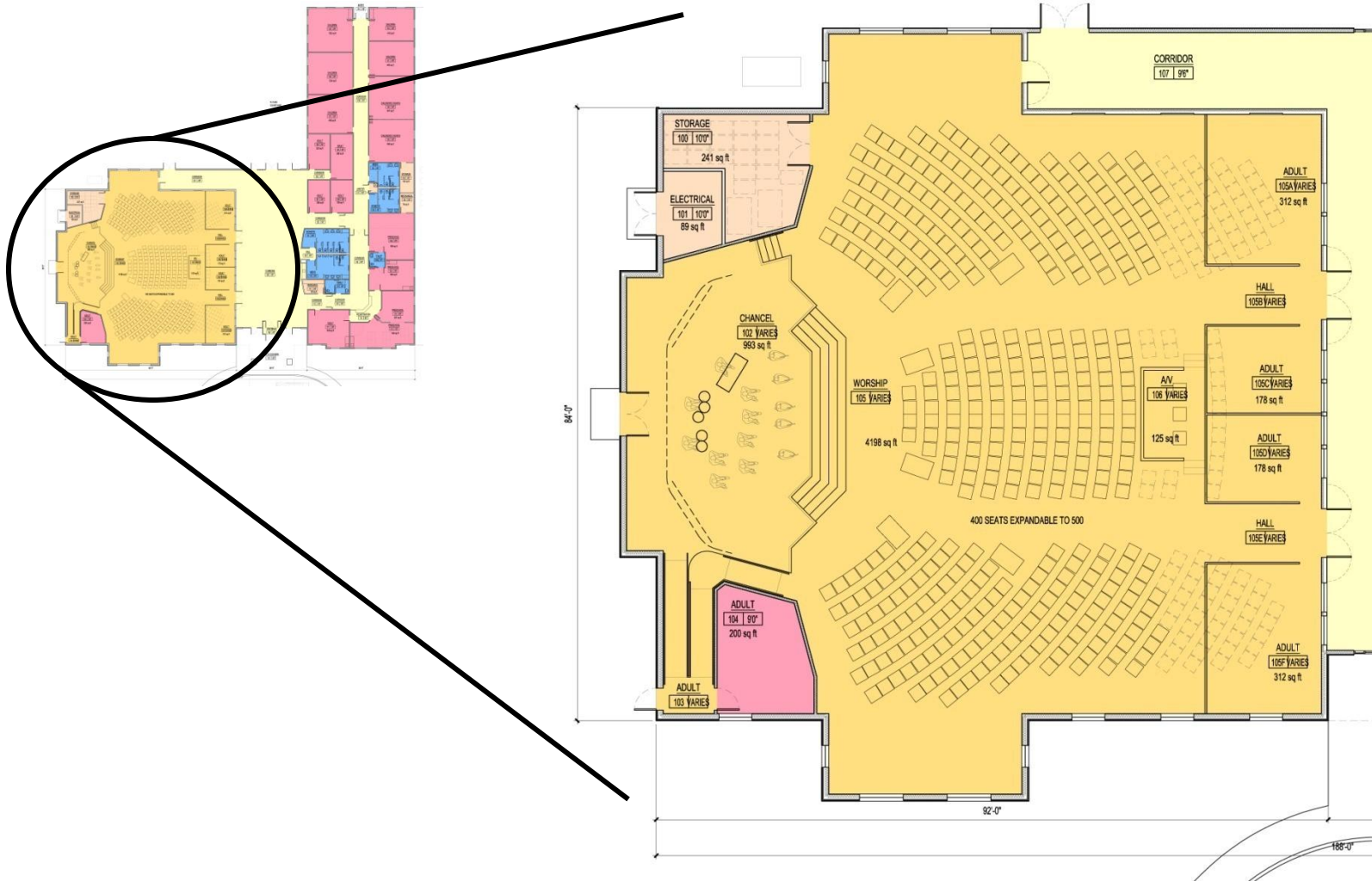

Phase 1 Entry/Fellowship

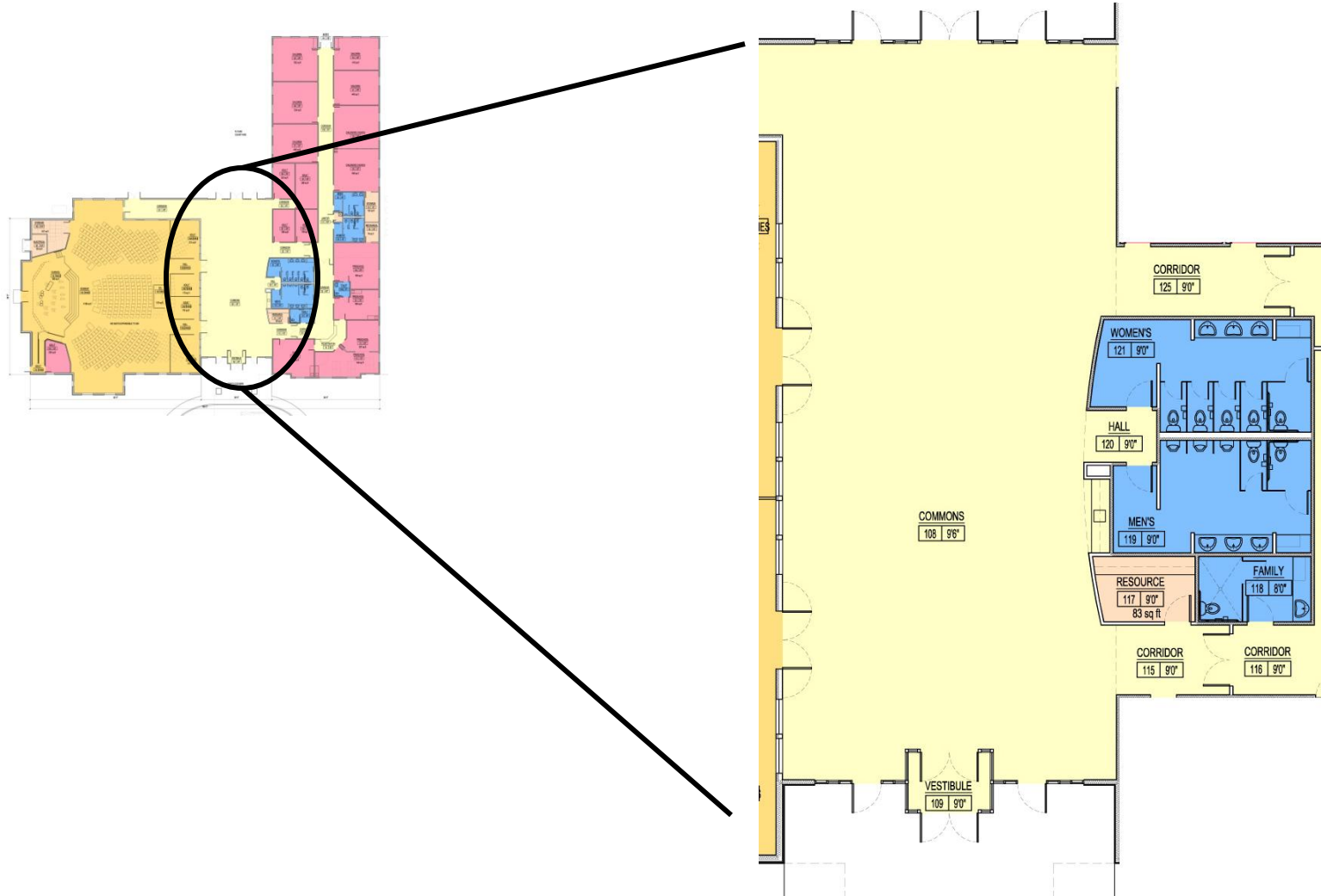

Phase 1 Nursery-Preschool

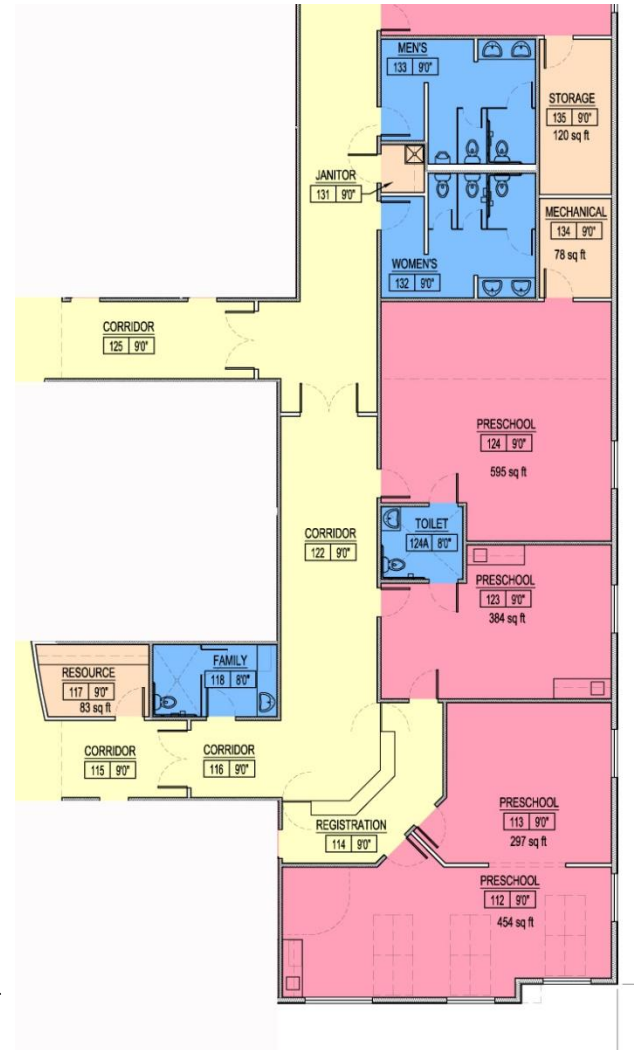
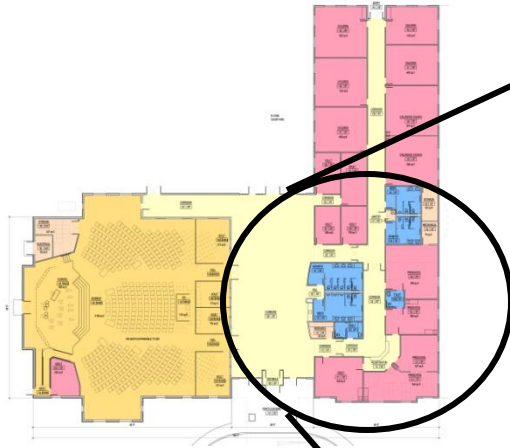

Phase 1 Children

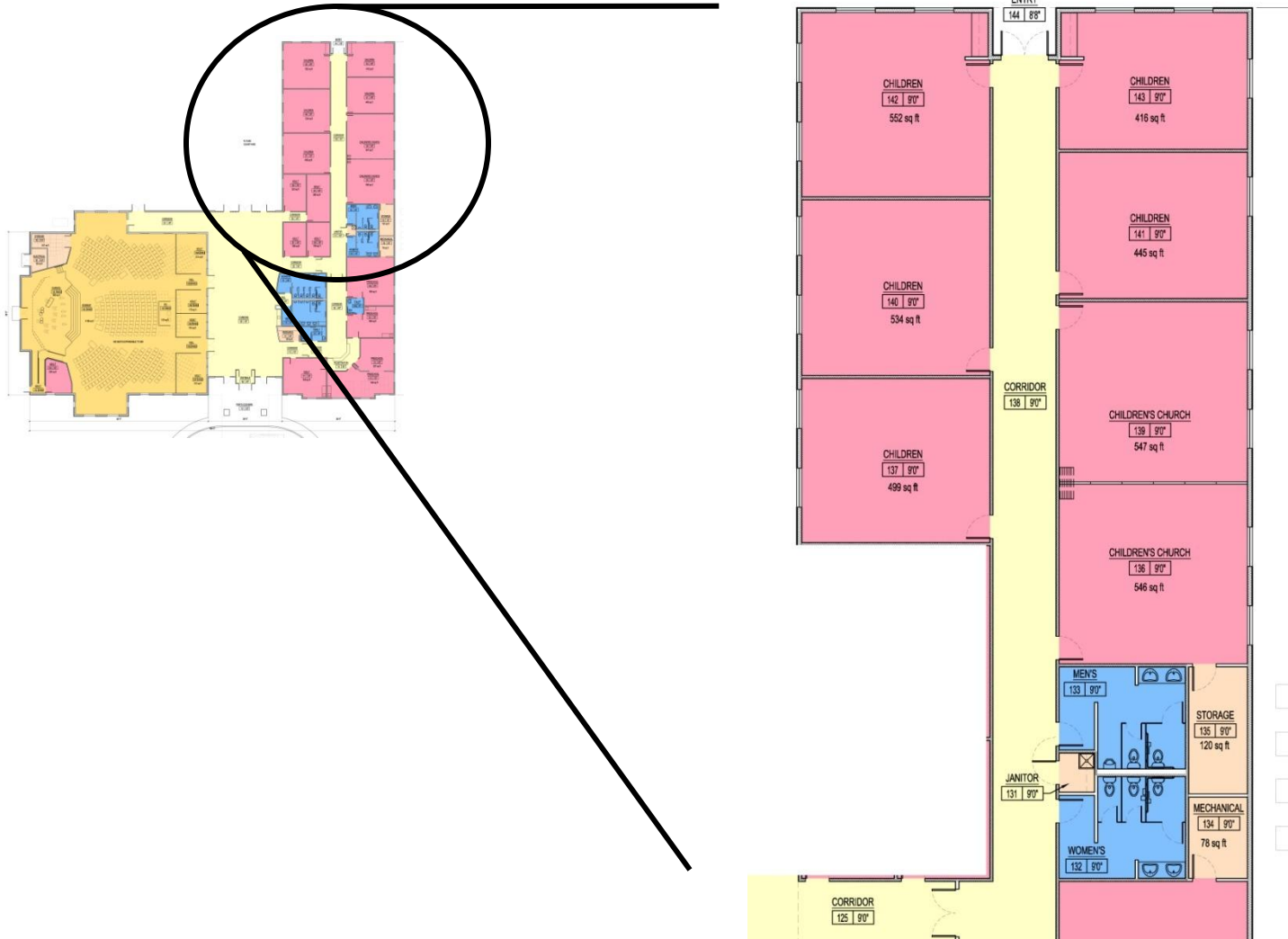

Phase 1 Youth

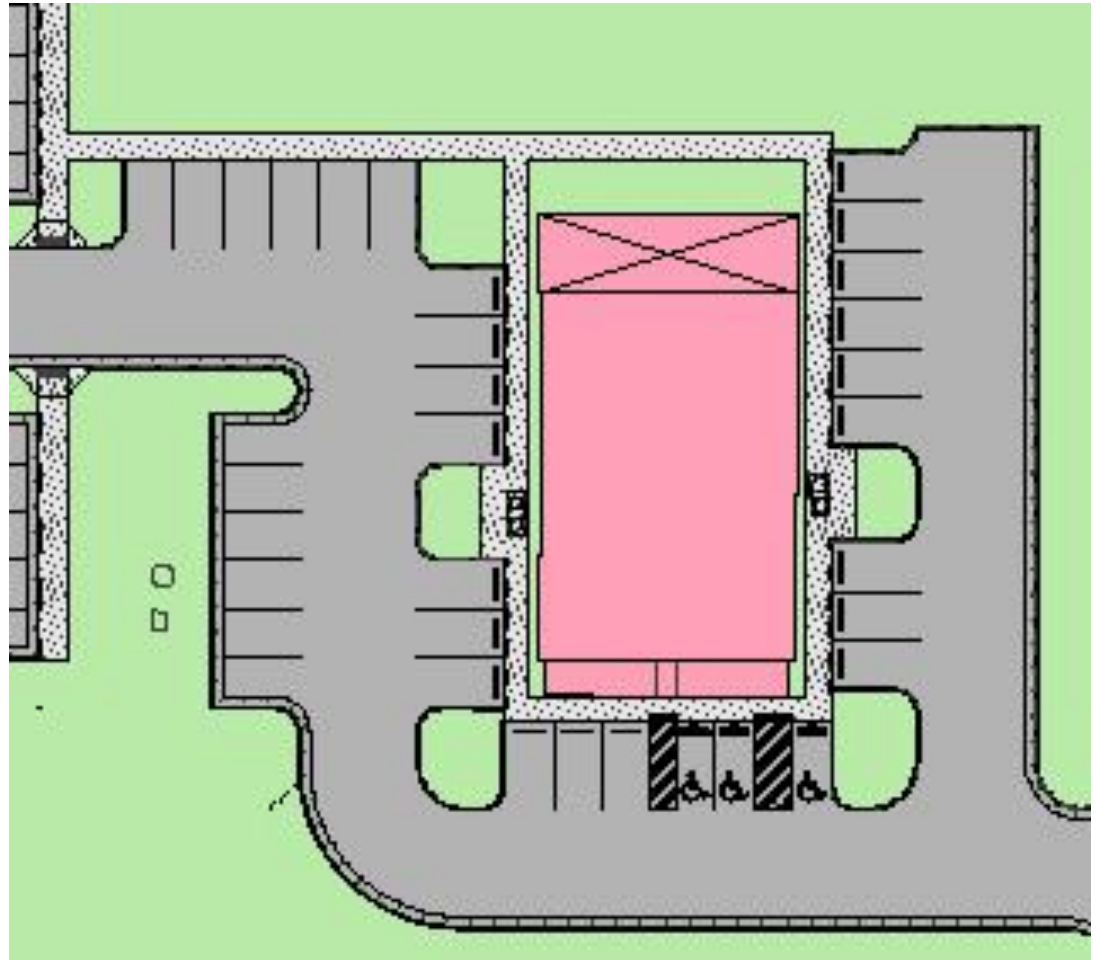
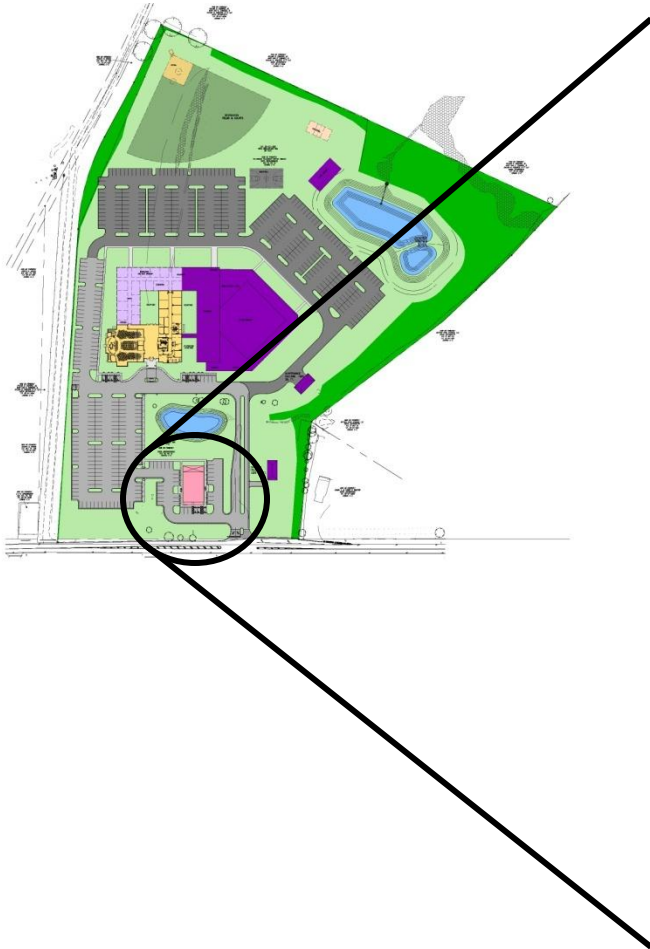

Phase 1 Adult Sunday School

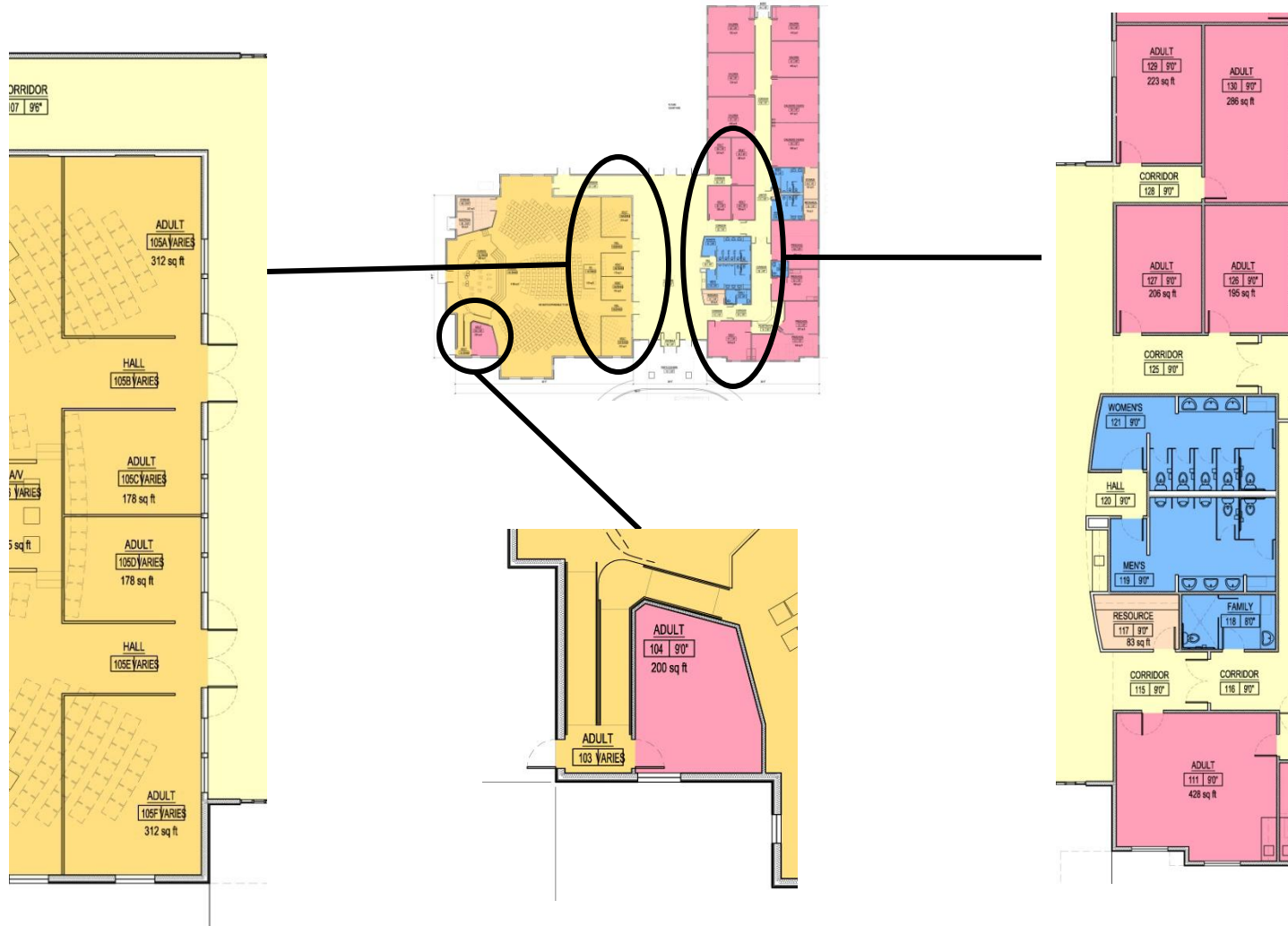

Phase 1 with possible Phase 2

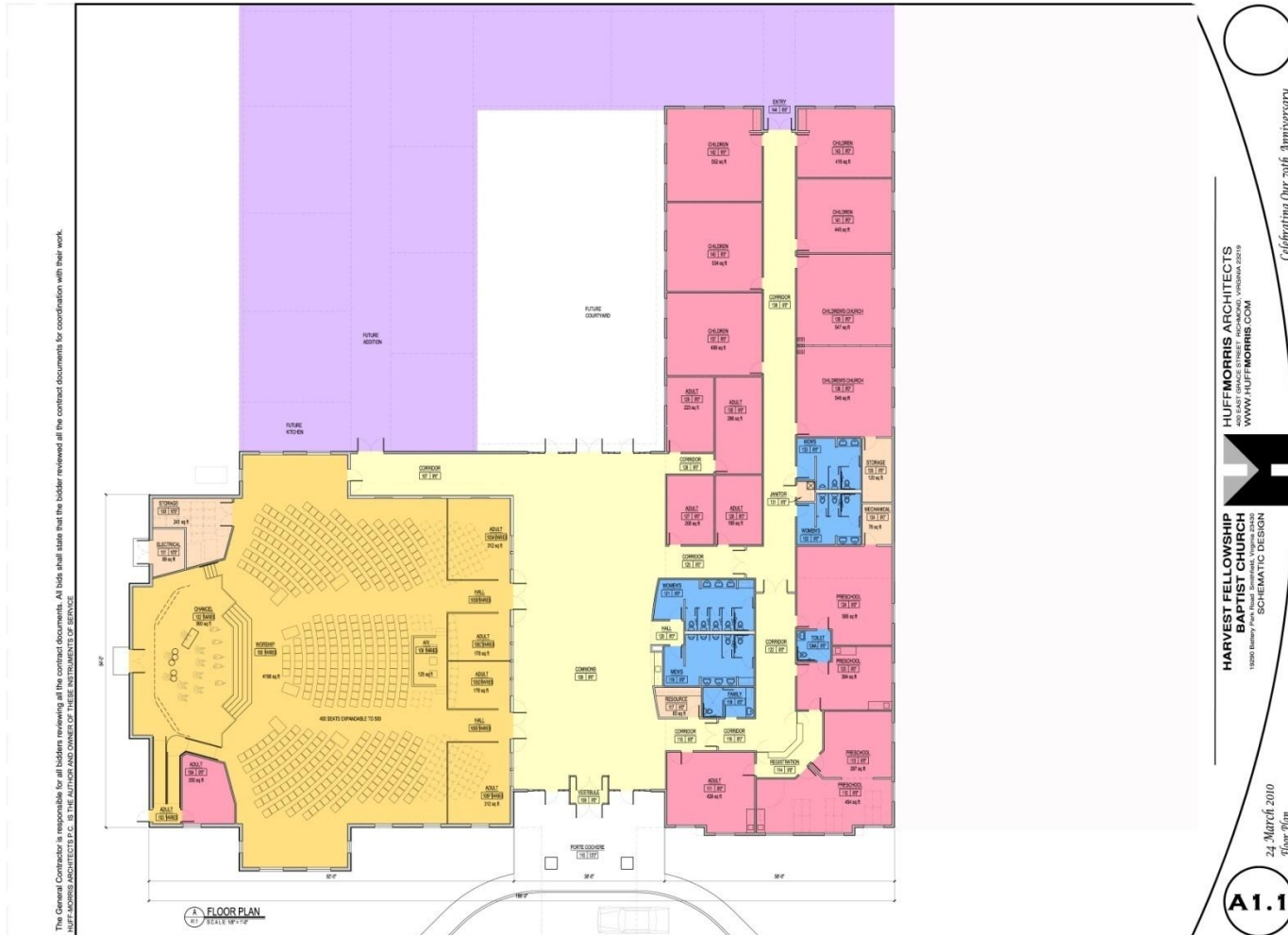

Elevation view - front



A WEST ELEVATION
SCALE: 1/8" = 1'-0"

Elevation view - right



Elevation view - back



Elevation view - left



 NORTH ELEVATION
SCALE: 1/8" = 1'-0"